

Toggle presses for manual operation

Item description/product images



Description

Material:

Press stand cast steel.

For push-pull clamp see K0088

Version:

Press stand painted black.

For push-pull clamp see K0088

Note:

The thrust clamps can be re-ordered as a complete assembly kit. See K0088 for specifications.

Accessory:

K0088

K0099

K0101

K0102

K0103

K0106

Drawing reference:

1) handle can be mounted right or left

Toggle presses for manual operation

Drawings

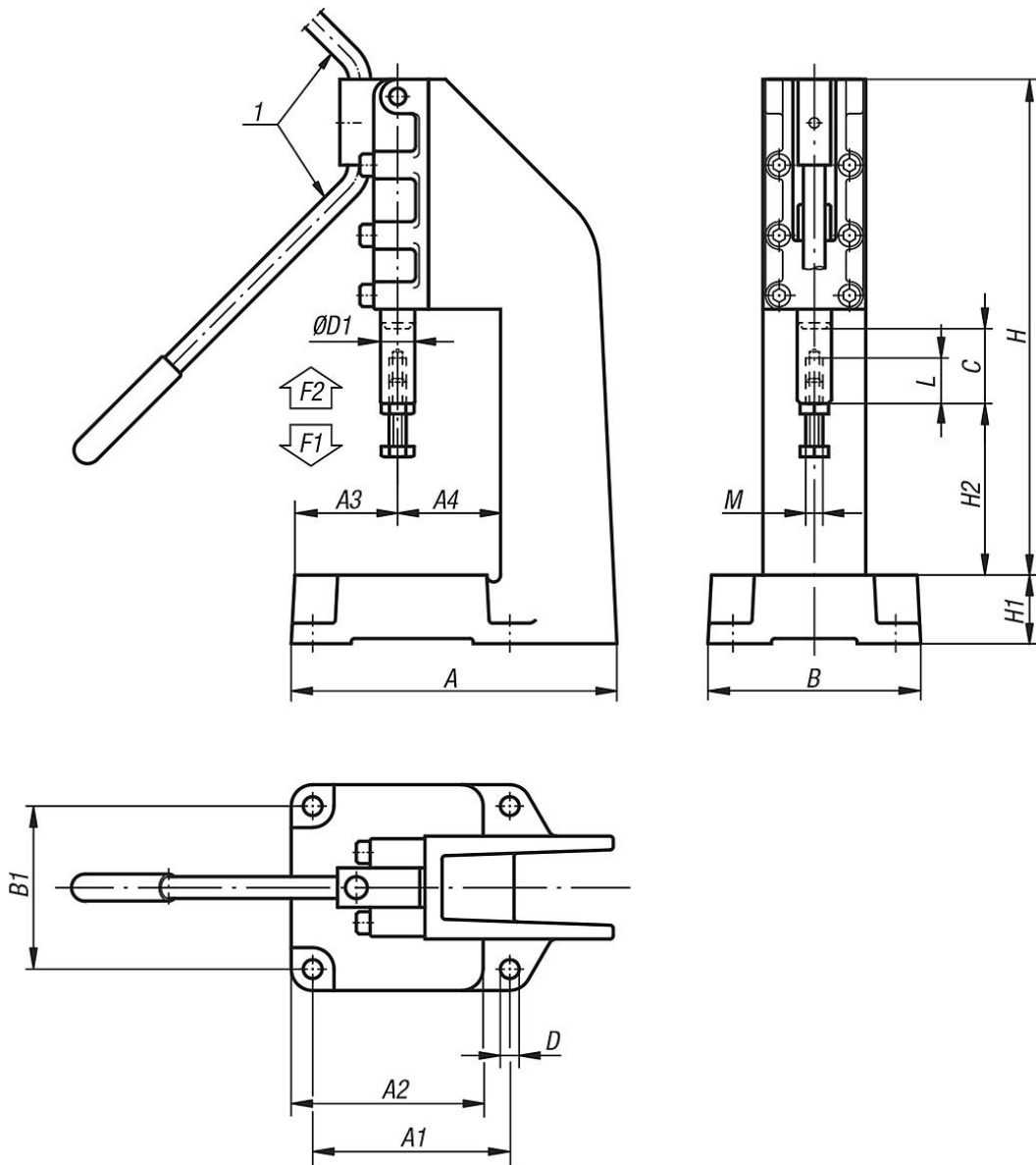

Overview of items

Toggle presses for manual operation

Order No.	A	A1	A2	A3	A4	B	B1	D	D1	H	H1	H2	L	M	C (travel)	Hand force FH N	Retaining force F2 N	Opening angle of handle
K0095.0600	150	95	94	50	50	100	80	9	14	202	30	75	30	M8	32	140	6000	185°
K0095.1200	192	115	112	60	60	120	95	11	20	290	40	100	40	M10	50	150	12000	185°
K0095.2500	238	145	142	75	75	150	125	11	25	418	50	120	60	M12	75	170	25000	185°
Order No.	Opening angle of handle		Hand force FH N		Retaining force F2 N		Clamping force F1 N											
K0095.0600	185°		140		6000		-											
K0095.1200	185°		150		12000		-											
K0095.2500	185°		170		25000		-											