

Self-aligning pads adjustable, with O-ring and exchangeable inserts

Item description/product images



Description

Material:

Body carbon steel.

Ball rust and acid resistant steel.

Inserts:

Form C, F, M tool steel

Form K POM

Form E stainless steel.

Form O stainless steel diamond impregnated.

Form P stainless steel with polyurethane surface.

Version:

Body tempered, black oxidised.

Ball hardened, bright.

Inserts:

Form C, F hardened, black oxidised.

Form M with carbide serrations, black oxidised.

Form K white.

Form E hardened, bright.

Form O diamond impregnated surface comparable to 100 grade abrasive grit.

Form P polyurethane surface, hardness 60 Shore.

Note:

Self-aligning pads are used to support and clamp unmachined and machined workpieces.

They also serve as stops, supports and thrust pads in fixtures and toolmaking.

The ball can be removed from the housing by applying light pressure to the socket head screw.

Ball secured against rotation.

Advantages:

Highly cost-effective as inserts can be exchanged.

The built-in O-ring holds the ball in place and keeps dirt and foreign particles out, ensuring uniform movement.

Self-aligning pads adjustable, with O-ring and exchangeable inserts

Drawings

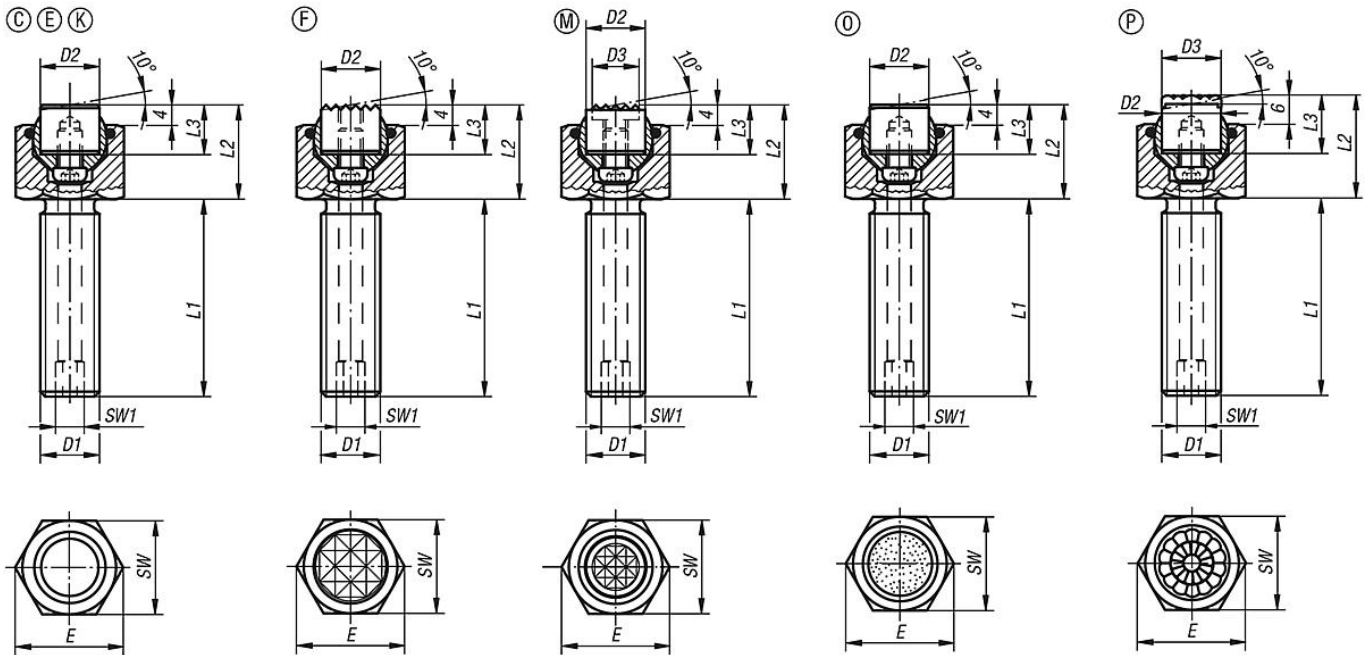

Overview of items

Order No.	Form	D1	D2	L1	L2	L3	E	SW	SW1	Ball Ø	Load rating max. kN (static load only)	Order No. steel insert
K0289.110X015	C	M10	10	15	17	10	19,6	17	3	13	19	K0385.10108
K0289.110X030	C	M10	10	30	17	10	19,6	17	3	13	19	K0385.10108
K0289.110X050	C	M10	10	50	17	10	19,6	17	3	13	19	K0385.10108
K0289.112X020	C	M12	12	20	19	10	21,9	19	5	15	30	K0385.12108
K0289.112X040	C	M12	12	40	19	10	21,9	19	5	15	30	K0385.12108
K0289.112X060	C	M12	12	60	19	10	21,9	19	5	15	30	K0385.12108
K0289.116X025	C	M16	16	25	23	10	27,7	24	6	20	50	K0385.16108
K0289.116X050	C	M16	16	50	23	10	27,7	24	6	20	50	K0385.16108
K0289.116X080	C	M16	16	80	23	10	27,7	24	6	20	50	K0385.16108
K0289.120X030	C	M20	20	30	24	10	34,6	30	8	23	85	K0385.20108
K0289.120X060	C	M20	20	60	24	10	34,6	30	8	23	85	K0385.20108
K0289.120X100	C	M20	20	100	24	10	34,6	30	8	23	85	K0385.20108
K0289.124X040	C	M24	25	40	30	10	41,6	36	10	28	121	K0385.25108
K0289.124X100	C	M24	25	100	30	10	41,6	36	10	28	121	K0385.25108