

## Recessed handles fold-down stainless steel

### Item description/product images

---



### Description

**Material:**

Stainless steel 1.4301.

**Version:**

High-gloss electropolished.

**Note:**

Stainless steel retractable grips with marginal installation depth. For base and mounting plates or drawers. With return spring. The grip automatically swivels back into its resting position after use.

**Drawing reference:**

1) for countersunk screws M4

Recessed handles fold-down stainless steel

Drawings

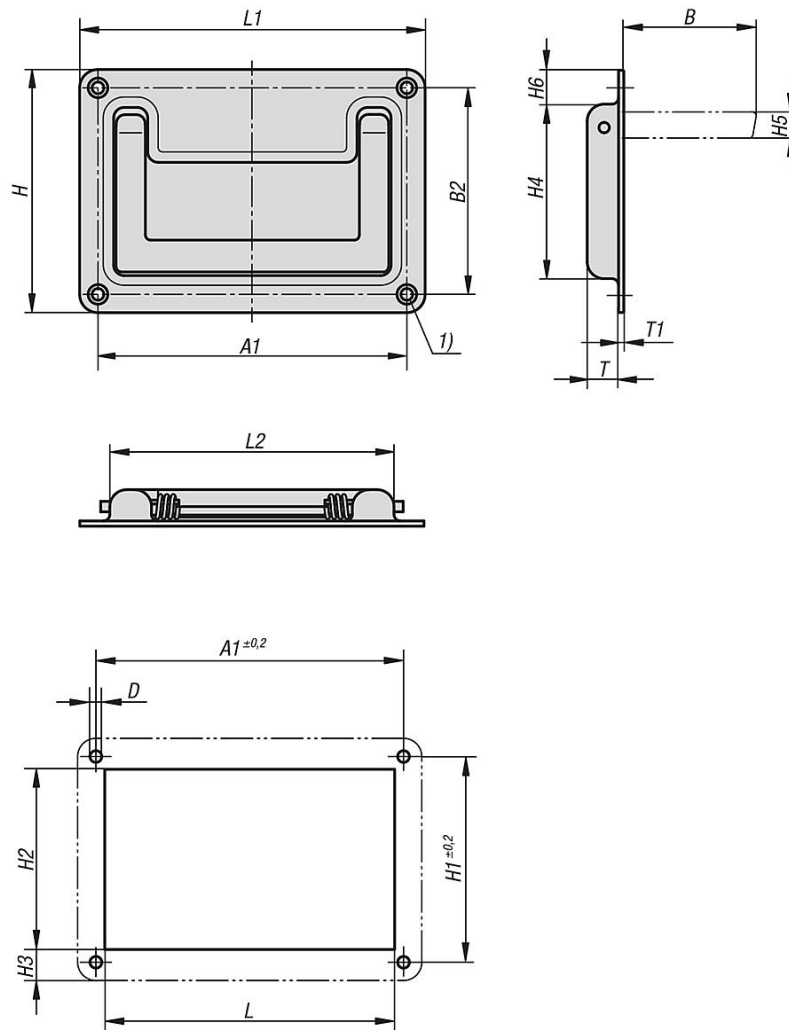

Overview of items

Recessed handles fold-down stainless steel

| Order No. | A1      | B  | B2 | D   | H  | H1     | H2 | H3   | H4 | H5 | H6 | L1  | L2  | T  | T1  |
|-----------|---------|----|----|-----|----|--------|----|------|----|----|----|-----|-----|----|-----|
| K1305.132 | 118±0,2 | 51 | 79 | 4,5 | 93 | 79±0,2 | 72 | 10,5 | 67 | 10 | 13 | 132 | 109 | 12 | 1,5 |