

## Crank handles aluminium with fold-away grip

### Item description/product images



### Description

#### Material:

Crank AlSi9Cu3 3.2163.

Cylinder grip thermoplastic PA6 and steel.

#### Version:

Crank black powder coated.

Thermoplastic black.

Steel parts black oxidised.

#### Note:

Similar to DIN 469.

### Drawings

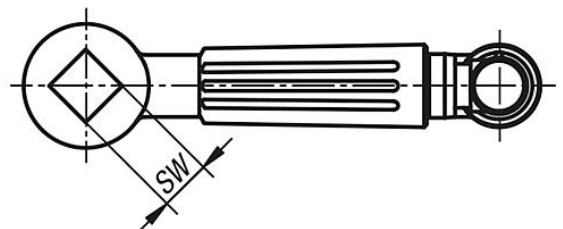
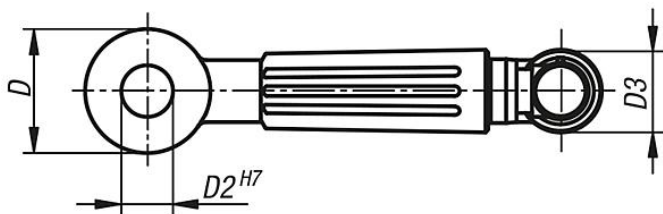
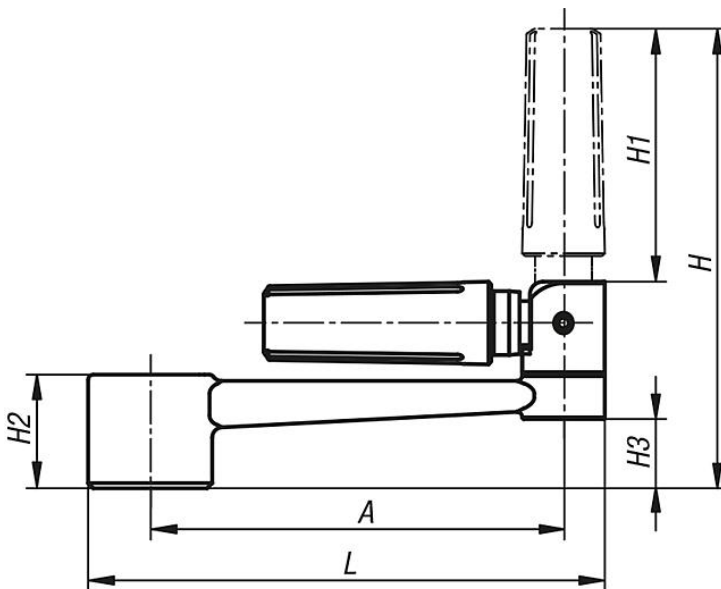

### Overview of items